

PARTS CATALOG

Workmaster 35 Compact Tractor

Print No. 47385540
8/2014



NEW HOLLAND

AGRICULTURE

GENERAL INFORMATION

1. Whenever the terms left and right are used, it should be understood to mean from a position facing in direction of travel.
2. Throughout this manual you may find common hardware not illustrated, but listed in the description column. The service part immediately preceding a hardware listing is the part using these particular items for mounting purposes. This hardware is not included with the service part or assembly when ordered as a replacement.
3. The illustrations show typical assemblies plus individual parts but in all cases may not show the exact shape or detail of parts required. However, the purpose for the illustrations is to identify parts performing like functions. Whenever possible illustrations are located at the beginning of each section or immediately adjacent to the applicable text.
4. CNH America LLC is continually striving to improve its products. We must, therefore, reserve the right to make improvements or changes when it becomes practical and possible to do so, without incurring any obligation to make changes or additions to the equipment sold previously.

CNH America LLC, Racine, WI 53404 U.S.A.

How to Use Your Parts Catalog

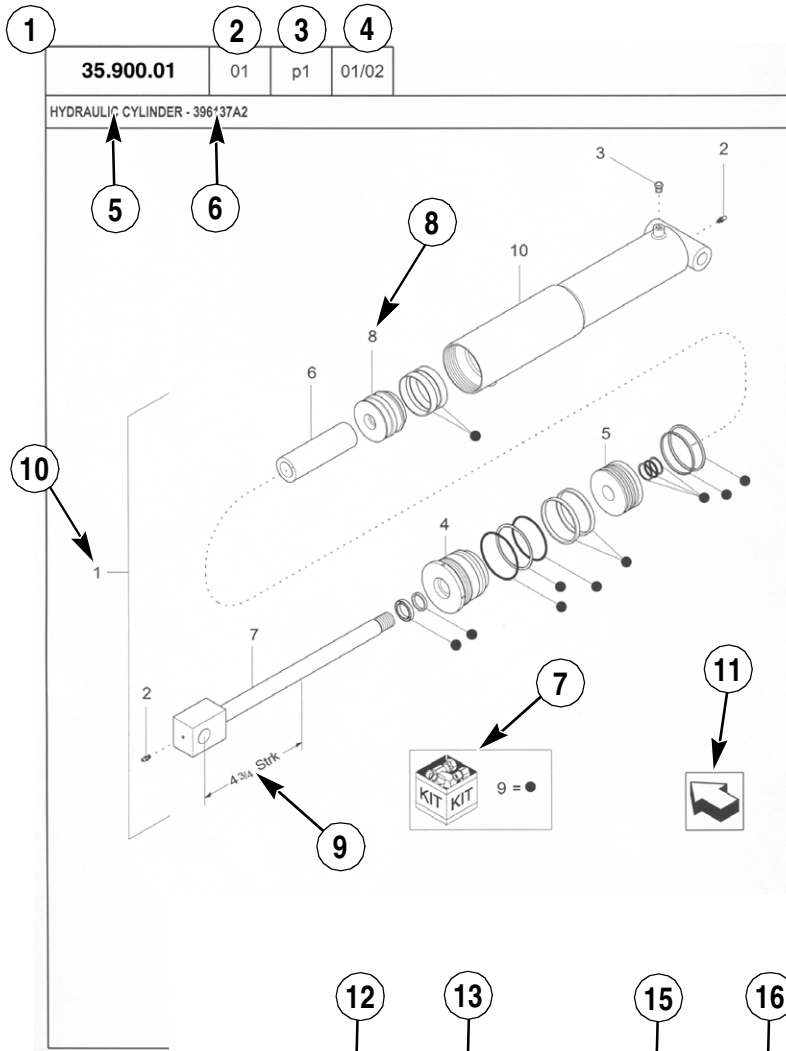

HYDRAULIC CYLINDER - 396137A2					
REF	FN	PART NUMBER	YR/SN	QTY	DESCRIPTION
1	1	396137A2	BTW 01/85 & 02/02	1	CYLINDER ASSY. 4-3/4 in strk, Inc 2-10
2		31-95	Before 01/85	2	FITTING
2		219-8	From 01/85	2	NIPPLE, LUBE Grease, 1/4 tpr x 17/32
3		{402475A2}		1	BREATHER
4		402474A1		1	CAP CYLINDER END
5		402468A1	BSN JJC0189200	1	PISTON ROD/GLAND
5		145221C3	ASN JJC0189200	1	PISTON
6		402471A1		1	SPACER
7		402473A1		1	ROD, PISTON
8		402469A1		1	PISTON ROD/GLAND
9		402476A1		1	PACKAGE, SEALS
10		NSS		1	NOT SERVICED SEPARAT CASE ASSEMBLY
(1) 08-20					
STANDARD			MODELS		

How to Use Your Parts Catalog

1. Figure Number
2. Sequence code within the Figure Number
3. Page number within the Sequence Code
4. Date of Printing (month / year)
5. Figure Description
6. General information regarding the figure
7. Parts supplied in repair kits per symbol reference
8. Figure call-out of the part number (REF)
9. Technical Specifications relating to the part indicated
10. Figure call-out includes bracketed items, the included items may also be listed in the additional description area
11. Orientation - Arrow indicates front of the machine
12. Footnote - Additional information relating to the part number. In this example, 08-20 equals another figure that this part is shown on.
13. Part Number
 - NSS = Non-serviced parts
 - Bracketed numbers = not available as service parts in this market
14. Not Available as service part in this market
15. YR/SN
 - Year
 - Before 01/85 = Part valid for production January 1985 and before
 - From 01/85 = Part valid for production from January 1985 and after
 - BTW 01/85 & 02/02 = Part valid for machines produced between January 1985 and February 2002.
 - Serial Number (P.I.N.)
 - BSN JJC0268800 = Part valid for serial number JJC0268800 and below
 - ASN JJC0268800 = Part valid for serial number JJC0268800 and above
 - BTW JJC0178000 & JJC0179000 = Part valid for serial numbers between JJC0178000 & JJC0179000
16. Total Quantity of the Part referred to in the page. The quantity can be replaced by the following indications:
 - AR = quantity as required
 - X = as required
17. Part Description
18. Additional description of the part to help confirm identification
19. Figure Notes
20. Model Number(s)

Explanation of Abbreviations

Abbreviation	Meaning
adj	adjustable
amp	ampere
AR	As required
ASN	Serial number and after / P.I.N. and after
barb	barb
blkhd	bulkhead
boss	boss
BSN	before serial number / before P.I.N
BTW	between
cc	cubic centimetre
chain	chain
cl	class
cp pt	cup point
CRS	Chrome Alloy Steel
CST	Carbon Steel
cu yd	cubic yard
deg	degree
dia	diameter
dr type	drive type
dry	dry
fc	face
fc sl	face seal
fem	female
fem PT	female pipe thread
fl	flare
ft	feet (or foot)
gal	gallon(s)
gr	grade
hd	head
hp	horsepower
ID	inside diameter

Abbreviation	Meaning
in	inch(es)
Inc.	includes
inv fl	inverted flare
K	kilo
kg	kilogram
L	litre
lb	pound(s)
lg	long
LH	left hand
LH thd	left hand thread
links	links
M	(prefix) metric thread size
m	metre
male	male
mm	millimetre
NF	National Fine
No.	number
NS	National Super Fine
OD	outside diameter
ohm	electrical unit of resis- tance
Or	O-ring
orifice	orifice
P	pitch
piece	piece
psi	pounds per square inch
PT	pipe thread
rd	round
rd holes	round holes
RH	right hand
RH thd	right hand thread
rpm	revolutions per minute

Explanation of Abbreviations

Abbreviation	Meaning
sl	self locking
slat	slat
spool	spool
sq	square
SST	Stainless Steel
st	self tapping
stem	stem
strk	stroke
sw	swivel
T	teeth
Teflon	Teflon
thin	thin
thk	thick
tpr	taper

Abbreviation	Meaning
tube	tube
type	type
V	volt(s)
W	watt(s)
way	way
wide	wide
X	as required
yd	yard

Dimensions

Metric and U.S. hardware dimensions do not show the numeric designations of standard coarse threads. A number following a semi colon (;) is the class or grade of hardware. A comma (,) represents the decimal point (.) used in U.S. dimensions.

TABLE OF CONTENTS

00.100.01	01	INITIAL STOCKING LIST - PLANNED MAINTENANCE - (1) UNIT/S
00.100.01	02	INITIAL STOCKING LIST - PLANNED MAINTENANCE - (5) UNIT/S
00.100.01	03	INITIAL STOCKING LIST - PLANNED MAINTENANCE & BASIC REPAIR - (1) UNIT/S
00.100.01	04	INITIAL STOCKING LIST - PLANNED MAINTENANCE & BASIC REPAIR - (5) UNIT/S
05.100.03	02	CAPACITIES, WORKMASTER 35/40
10.000.00		PICTORIAL INDEX - ENGINE
10.001.AB	01	CRANKCASE, ASSY
10.001.AB	02	CRANKCASE, ASSY
10.001.AD		ENGINE OVERHAUL GASKETS
10.101.AA		CYLINDER HEAD & RELATED PARTS
10.101.AB		VALVE COVER
10.101.AM		VALVE / ROCKER / LIFTER
10.102.AP		OIL PAN
10.102.BB		TIMING GEAR COVER / GEARS
10.103.AA		CRANKSHAFT / FLYWHEEL
10.105.AB		PISTON & CONNECTING ROD
10.106.AA		CAMSHAFT
10.202.BD		AIR CLEANER ASSY
10.216.AI		FUEL TANK & RELATED PARTS
10.218.AE		FUEL SYSTEM INJECTOR
10.218.AQ		FUEL FILTER & CARTRIDGE
10.220.AA	01	THROTTLE CONTROL
10.220.AA	02	THROTTLE CONTROL LINKAGE
10.254.AC		EXHAUST MANIFOLD
10.254.AI		EXHAUST SYSTEM W/ MUFFLER
10.254.AM		INTAKE MANIFOLD
10.304.AE		OIL SYSTEM
10.400.BB		WATER PUMP & RELATED PARTS
10.400.BE		RADIATOR & RELATED PARTS
18.100.AF		CLUTCH PEDAL & LINKAGE
18.110.AB		CLUTCH & DISC ASSY
21.110.AB		CLUTCH HOUSING
21.114.AL		TRANSMISSION HOUSING

TABLE OF CONTENTS

21.130.AZ	01	SHIFT LEVER & FORK - MAIN GEAR
21.130.AZ	02	SHIFT LEVER & FORK - FORWARD / REVERSE
21.130.BC		RANGE GEAR CONTROLS
21.140.AE	01	RANGE GEAR SHAFT 2WD W/MECHANICAL TRANS
21.140.AE	02	RANGE GEAR SHAFT 4WD W/MECHANICAL TRANS
21.140.AM		MAIN SHAFT MECHANICAL - INDP
23.314.AG		FRONT & REAR DRIVE SHAFTS - 4WD
25.100.AA		FRONT AXLE ASSY - 4WD
25.100.AD		FRONT AXLE HOUSING - 4WD
25.102.AD		HYDRO GEAR FRONT DIFFERENTIAL
25.108.AC		FRONT AXLE HOUSING - 4WD
25.108.AN		FRONT FINAL DRIVE - 4WD
27.100.AB		REAR AXLE
27.106.AC		REAR DIFFERENTIAL
27.106.AK	01	DIFFERENTIAL LOCK - MECHANICAL
27.106.AK	02	DIFFERENTIAL LOCK - HST
29.130.AC		DAMPER - HYDROSTATIC TRANSMISSION
29.200.AN	01	HST CONTROLS - FORWARD & REVERSE
29.200.AN	02	HST CONTROLS - CRUISE CONTROL
29.200.AN	03	HST CONTROLS - BRAKE
29.200.AN	04	HST CONTROLS - PARKING BRAKE
29.202.AA		TRANSMISSION HOUSING
29.202.AI		CLUTCH HOUSING
29.202.AJ	01	RANGE GEAR SHAFT 2WD W/HST TRANS
29.202.AJ	02	RANGE GEAR SHAFT 4WD W/HST TRANS
29.204.AJ		TRANSMISSION OIL COOLER - HST
29.218.AO		HST DRIVE PUMP
31.101.AB		PTO DRIVE SHAFT
31.101.AC	01	SHIFT LEVER & FORK - PTO - 4WD
31.101.AC	02	SHIFT LEVER & FORK - M/PTO - 4WD
31.101.AD		PTO HARDWARE & CAPS
31.110.AI		PTO SHIELD FLIP UP
31.110.AP	01	PTO SHAFT MECHANICAL
31.110.AP	02	PTO SHAFT HST

TABLE OF CONTENTS

31.142.AI		TRANSMISSION CONTROL VALVE - INDP PTO
33.120.AG		BRAKE CONTROLS - MECHANICAL
33.204.AD		BRAKE ASSY
35.100.AR		HYDRAULIC LINES
35.100.BI		HYDRAULIC LIFT ASSEMBLY
35.100.BK		HYDRAULIC LIFT HOUSING
35.114.AA		LIFT CONTROL VALVE & LINK
35.116.AH		HYDRAULIC CYLINDER - DRAFT & LINK
35.204.BE		REMOTE CONTROL VALVE - W/O RCV
35.724.AA		FRONT OUTLET & LOADER VALVE
37.100.AA		DRAWBAR HITCH - TELESCOPIC
37.108.AE		HYDRAULIC CONTROL LEVER
37.110.AE		UPPER LINK BRACKET - W/O DRAFT
37.120.AA	01	LIFTING ROD - NON LEVELING
37.120.AA	02	UPPER LINK / LOWER LINK - GENERAL
37.120.AL		POSITION & DRAFT CONTROL LEVER
37.120.AO	01	LOWER LINK W/FLEX ENDS
37.120.AO	02	UPPER LINK / LOWER LINK - TELESCOPIC
37.120.AO	03	CHECK LINK - TELESCOPIC STABILIZER
39.100.AY		MAIN FRAME
39.140.AF		FRONT, BALLAST
41.101.AJ		STEERING COLUMN & WHEEL
41.106.AD		TIE-ROD ASSY & LINK - 4WD
41.216.AN		STEERING CYLINDERS, LINES & PUMP - 4WD
41.216.AU	01	STEERING SUPPLY & RETURN LINES - MECHANICAL
41.216.AU	02	STEERING SUPPLY & RETURN LINES - HST
44.511.AE		FRONT WHEELS
44.520.AB		REAR WHEELS
55.201.AE		STARTER MOTOR
55.202.AD		GLOW PLUG
55.301.AA		ALTERNATOR ASSY
55.302.AI		BATTERY - 80A
55.404.BS		LAMPS
55.510.BP		WIRING HARNESSSES - HST & MECHANICAL

TABLE OF CONTENTS

55.511.AP		ELEC CONNECTOR - 7 POLE
55.512.BG		INSTRUMENT PANEL
88.031.01	01	MID PTO DRIVE KIT
88.031.01	02	DRIVELINE - BREAKDOWN
88.031.01	03	MALE HALF DRIVELINE - BREAKDOWN
88.031.01	04	MALE HALF DRIVELINE - DECALS
88.031.02		MID PTO CONTROL KIT
88.035.01		REMOTE CONTROL VALVE KIT - Q/COUPLER 2
88.035.02		REMOTE CONTROL VALVE KIT - Q/COUPLER 4
88.035.03		DRAFT CONTROL KIT
88.035.04		HYDRAULIC KIT - 920GH & 110TL
88.037.01		LOWER LINK KIT - W/FLEX ENDS
88.039.01	01	MALE QUICK HITCH & SUBFRAME KIT - SUBFRAME
88.039.01	02	MALE QUICK HITCH & SUBFRAME KIT - MALE QUICK HITCH
88.039.02		SUBFRAME KIT - 920GH & 110TL
88.055.01		HORN & SWITCH KIT
88.055.02		KIT, BLOCK HEATER
88.090.01		GRAB HANDLE KIT
88.090.02		GRILLE, GUARD, KIT
88.100.14		DIA KIT, WORKLIGHT KIT ROPS MOUNTED - 87702589
90.102.AD		HOOD SUPPORT
90.108.03		SLOW MOVING VEHICLE - SMV
90.108.AC		DECALS
90.114.AQ		ROPS - FOLDABLE
90.116.BA		FENDER
90.118.BX	01	STEP & MOUNT W/HST TRANS
90.118.BX	02	STEP & MOUNT W/MECHANICAL TRANS
90.120.AD		SEAT, NON-SUSPENSION - GRAY
90.120.AU		HOOD

SECTION INDEX

TOP LEVEL

00.100.01	01	INITIAL STOCKING LIST - PLANNED MAINTENANCE - (1) UNIT/S
00.100.01	02	INITIAL STOCKING LIST - PLANNED MAINTENANCE - (5) UNIT/S
00.100.01	03	INITIAL STOCKING LIST - PLANNED MAINTENANCE & BASIC REPAIR - (1) UNIT/S
00.100.01	04	INITIAL STOCKING LIST - PLANNED MAINTENANCE & BASIC REPAIR - (5) UNIT/S

00.100.01

01

p1

8/2014

INITIAL STOCKING LIST - PLANNED MAINTENANCE - (1) UNIT/S

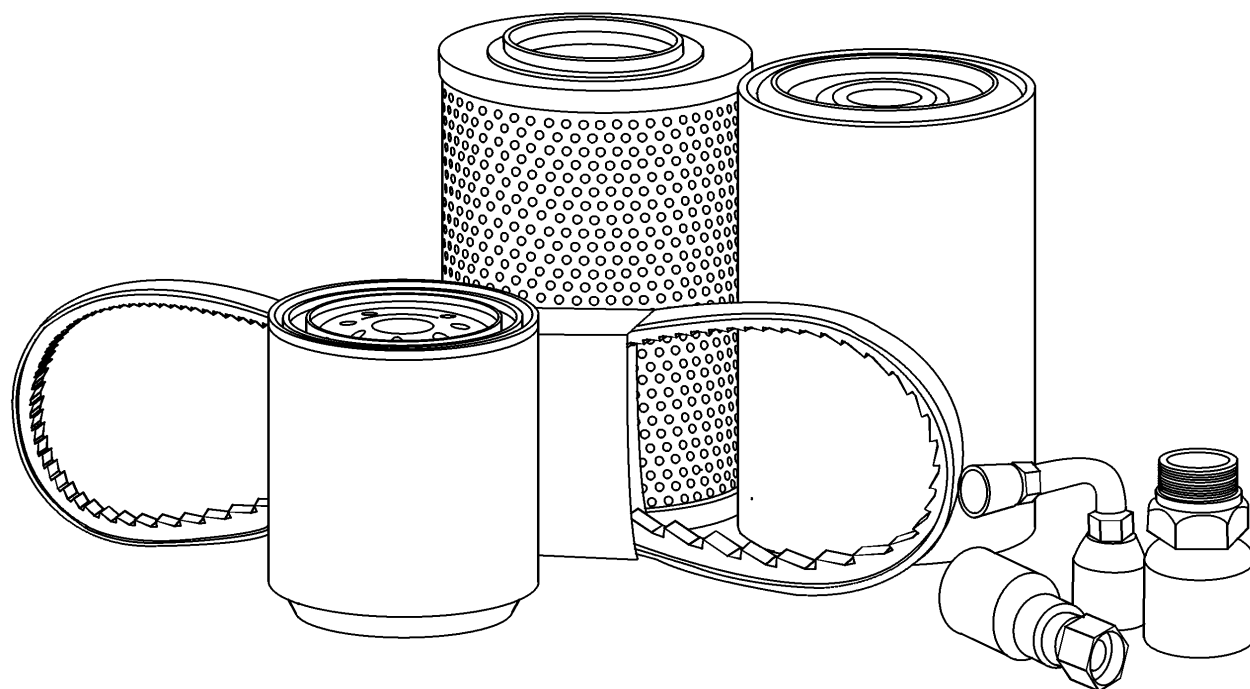

00.100.01

01

p1

8/2014

INITIAL STOCKING LIST - PLANNED MAINTENANCE - (1) UNIT/S

REF FN	PART NUMBER	YR/SN	QTY DESCRIPTION
1	87682998		1 AIR FILTER Primary
2	MT40006977		1 FILTER Oil
3	MT40006997		1 CARTRIDGE Fuel Filter
4	MT40007487		1 BELT Low Edge, Fan
5	MT40007563		1 FILTER Trans Oil
6	MT40007638		1 HYDRAULIC OIL FILTER
7	MT40049447		1 AIR FILTER Safety, 259.8 +/-1.5
			WORKMASTER 35

00.100.01

02

p1

8/2014

INITIAL STOCKING LIST - PLANNED MAINTENANCE - (5) UNIT/S

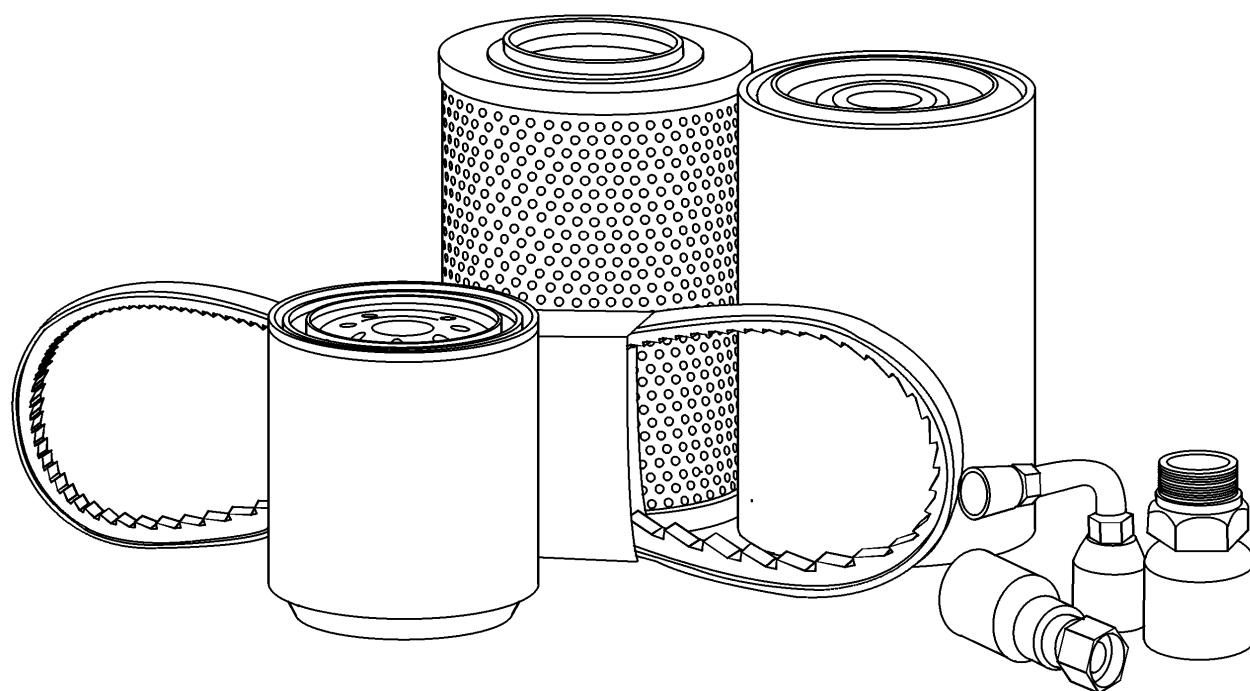

00.100.01

02

p1

8/2014

INITIAL STOCKING LIST - PLANNED MAINTENANCE - (5) UNIT/S

REF FN	PART NUMBER	YR/SN	QTY DESCRIPTION
1	87682998		3 AIR FILTER Primary
2	MT40006977		3 FILTER Oil
3	MT40006997		3 CARTRIDGE Fuel Filter
4	MT40007487		3 BELT Low Edge, Fan
5	MT40007563		3 FILTER Trans Oil
6	MT40007638		3 HYDRAULIC OIL FILTER
7	MT40049447		3 AIR FILTER Safety, 259.8 +/-1.5
			WORKMASTER 35

00.100.01

03

p1

8/2014

INITIAL STOCKING LIST - PLANNED MAINTENANCE & BASIC REPAIR - (1) UNIT/S

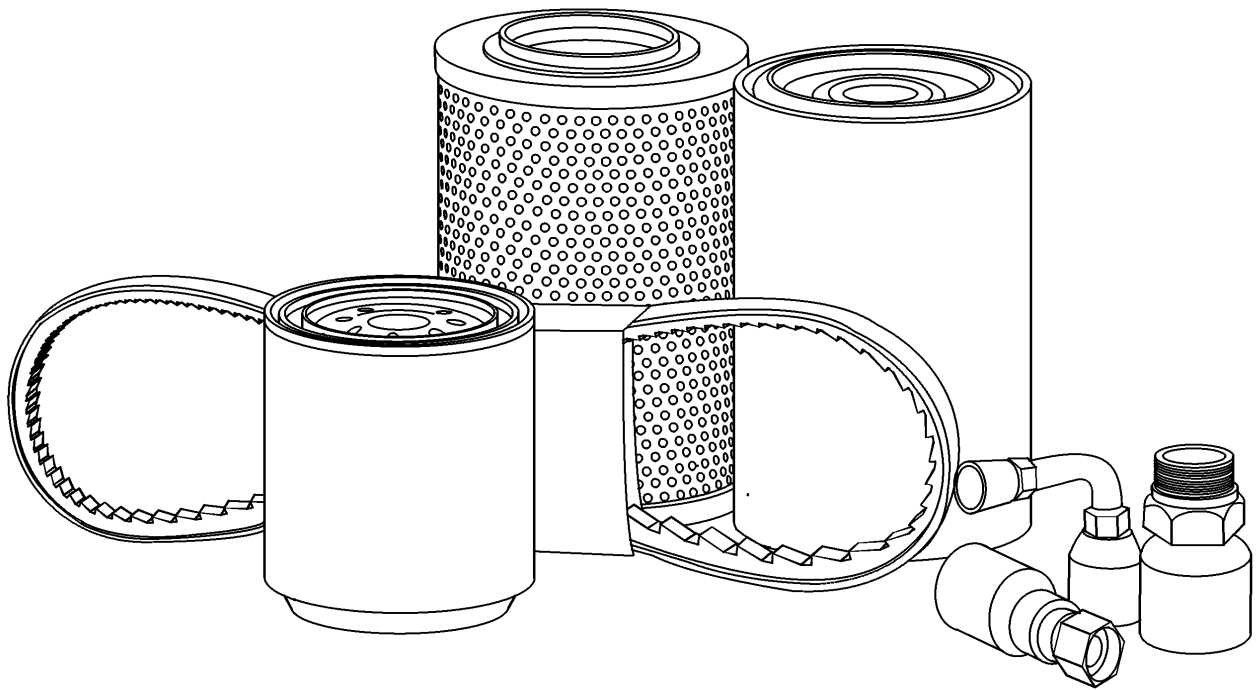

00.100.01

03

p1

8/2014

INITIAL STOCKING LIST - PLANNED MAINTENANCE & BASIC REPAIR - (1) UNIT/S

REF FN	PART NUMBER	YR/SN	QTY DESCRIPTION
1	MT40266850		1 IGNITION KEY
2	MT40006773		1 CAP Fuel Tank
3	MT40012409		1 DIPSTICK Oil Pan
4	MT40032531		1 SWITCH Horn
5	MT40181437		1 FUEL GAUGE On Fuel Tank
6	MT40224598		1 RADIATOR HOSE Lower/Inlet
7	MT40224599		1 RADIATOR HOSE Upper/Outlet
8	MT40007624		6 PLUG 11V, 20A Glow
9	MT40007156		1 TEMPERATURE SENDER 50° - 120° Unit
10	MT40007175		1 RELAY Starter
11	MT40007191		1 RELAY Glow Plug
12	MT40007202		2 BULB 12V/23W
13	MT40007203		2 BULB 12V/21W/5W
14	MT40007443		1 GAUGE Oil Level
15	MT40007663		1 THERMOSTAT Coolant
16	MT40007802		1 MFD SWITCH Oil Pressure
17	MT40059365		2 BULB 12V/40-45W
18	MT40185307		1 SWITCH PTO Select
19	MT40186104		3 FUSE Main 50AMP
20	MT40194373		1 SWITCH Combination
21	MT40196911		1 FLASHER UNIT ASAE
22	MT40230238		2 QUICK FEMALE COUPLING 1/2"
23	MT40234130		1 RELAY Headlamp
24	MT40242668		1 RADIATOR CAP
			WORKMASTER 35

00.100.01

04

p1

8/2014

INITIAL STOCKING LIST - PLANNED MAINTENANCE & BASIC REPAIR - (5) UNIT/S

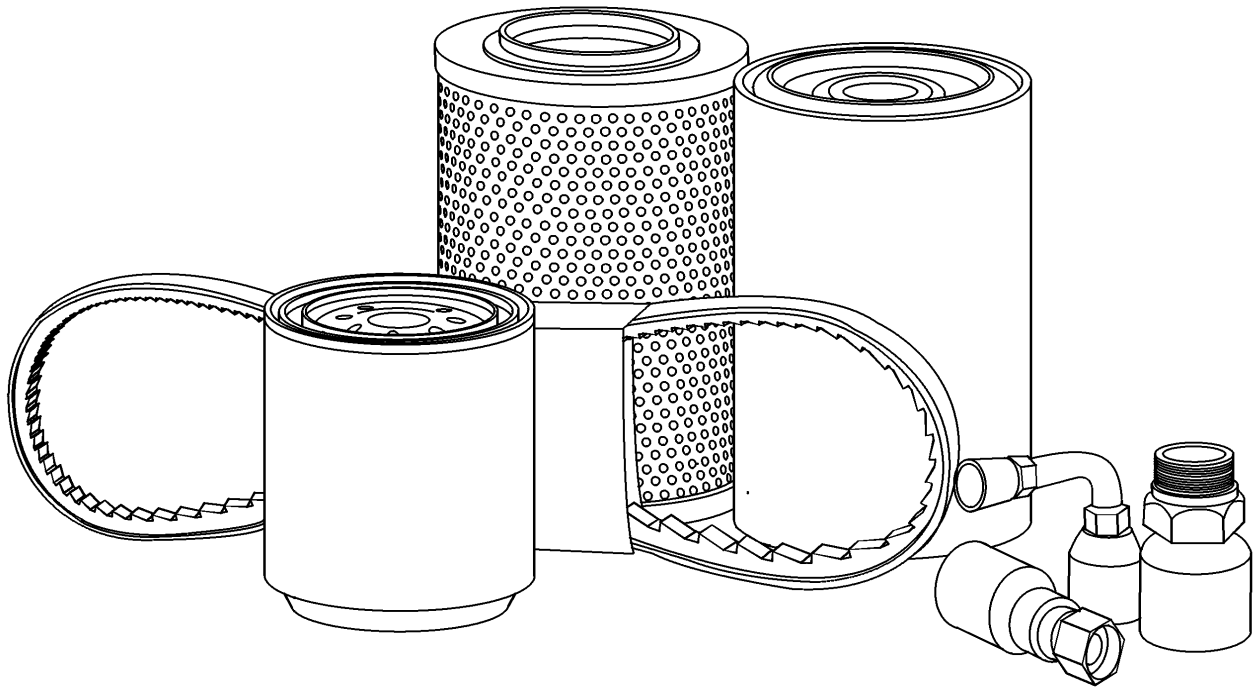

**Thanks very much for your reading,
Want to get more information,
Please click here, Then get the complete
manual**

JustClickHere 

NOTE:

**If there is no response to click on the link above,
please download the PDF document first, and then
click on it.**

**Have any questions please write to me:
admin@servicemanualperfect.com**